

Manyo / 1st Floor Banquet Rooms

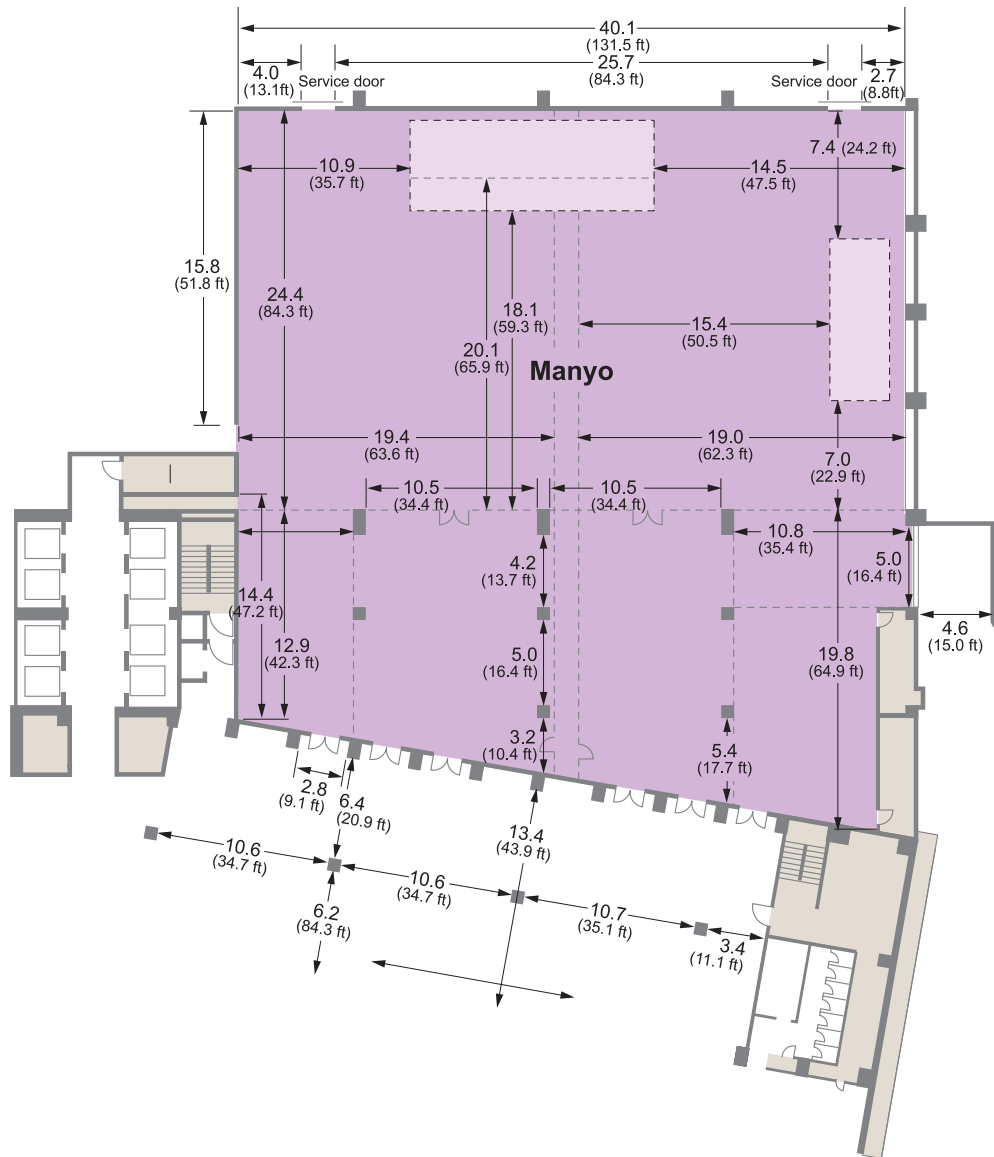

Main installations

Rising stages

- Center front stage : Can be divided into four
 - : 82 sq. m. (14.68 m x 5.56 m)
 - : 881 sq. ft. (48.16 ft x 18.24 ft)
 - Four batons to put up signs or decorations in two places
 - Stage elevation of 30 cm (0.98 ft) to 90 cm (2.95 ft)
- Side stage : 35 sq. m. (10.02 m x 3.50 m)
 - : 376 sq. ft. (32.87 ft x 11.48 ft)
 - Stage elevation of 30 cm (0.98 ft) to 90 cm (2.95 ft)

Equipment

- Sound / lighting room. Fully furnished with sound and light-control equipment
- Lighting batons
- Standby power supply
- Speakers : Ceiling speakers
 - Ceiling-hanging speakers
- Electrically-operated screen

Lobby

Cloakroom, restrooms, public-phone section, sofas, and table sets are always available. The lobby is luxurious with a combination of marble walls and bracket lights. The lobby can be used as a reception room, waiting room, or guest room.

Service entrance

You can easily carry even large exhibits in and out, such as a car, using the side service entrance.

HOTEL PACIFIC TOKYO

3-13-3 Takanawa, Minato-ku, Tokyo 108-8567
 In front of the Takanawa-guchi exit of Shinagawa Station
 Tel: (81)(3)3445-6711